

# DS KIT PLUS CANOPY TAKEDOWN INSTRUCTIONS (10' x 10'')



877.HUT.LIVE ☎ 877.488.5483  
hutshop.com



**STEP 1**  
With one or two people, **REMOVE THE CANOPY TOP** from the partially closed frame.



**STEP 2**  
With the canopy at its lowest height position, gently close the outer frame legs until the frame is completely closed.



**STEP 3**  
Open Carry Bag and place open end of bag over top of Canopy Frame and slide bag down until the frame is completely covered and close zipper.

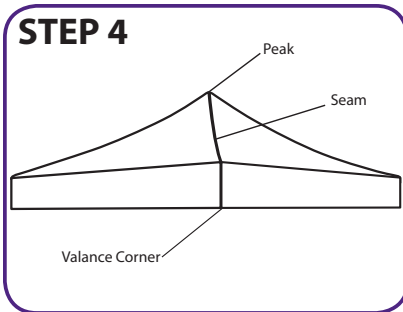

**STEP 4**  
Fold the Canopy Top. With the Person 1 holding the peak of the Canopy Top, Person 2 follows the seam from the peak to one of the valance corners.

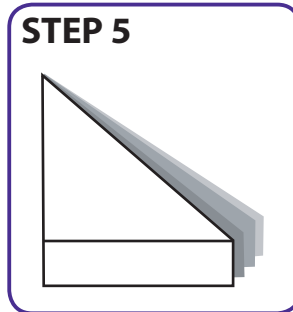

**STEP 5**  
Holding the valance corner in one hand, Person 2 takes the next valance corner with the other hand and folds both corners to meet, repeating step for all valance corners.

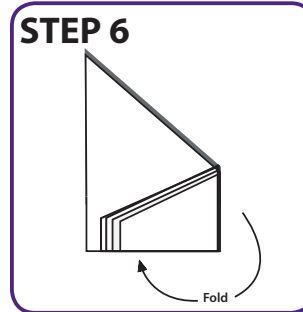

**STEP 6**  
With the folded Canopy Top in the shape of a triangle, take the valance corners and fold as illustrated above.

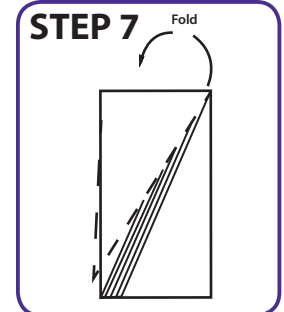

**STEP 7**  
Take the peak corner and fold as illustrated above.

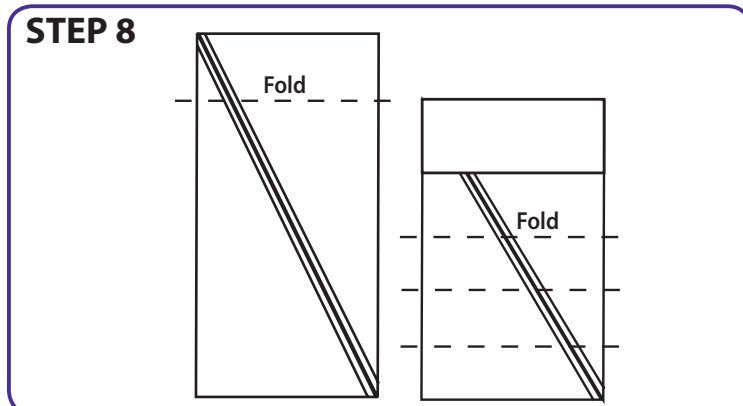

**STEP 8**  
From one end of the folded Canopy Top, fold top in 6-inch increments until the other end is reached. Slide the folded Canopy Top into the side pocket of Carry Bag and secure with Velcro® fastener.



P.O. Box 1003, Arlington, TN 38002

hutshop.com